

TigerStop Face Plate

Description and Use

Steel face plates are used to clad the TigerStop fence beam for applications in which the materials being processed could damage the aluminum surface of the beam.

Installation

1. Remove the plastic u-slots from the front face of the TigerStop.
2. Lay the face plates out in front of the Tigerstop in the desired positions.

If you must cover the Serial Number stamped in the extrusion, be sure to record the serial number or mark it somewhere else on the beam so you will have it when contacting TigerStop support.

3. Starting at the end closest to the saw, place the face plate in position and mark through the holes, below the slots, with a Sharpie or similar pen the hole locations.

It is best to mark the hole positions for only one face plate at a time, marking for the next face plate after the first is installed.

4. Using the marks as a reference, insert the T-nuts by tipping them in sideways into the slots. The foam on the back of the T-nut keeps it pressed to the front of the slot so you can easily engage the screws.
5. Tighten the screws with a 5/32" allen wrench.

FP04 COMPONENT LIST		
QTY	PART#	DESCRIPTION
1	M0950	Steel Face Plate 4'
12	F0390	T-Nut
12	F1477	Screw 1/4-20 x 3/8"
FP06 COMPONENT LIST		
QTY	PART#	DESCRIPTION
1	M0955	Steel Face Plate 6'
16	F0390	T-Nut
16	F1477	Screw 1/4-20 x 3/8"

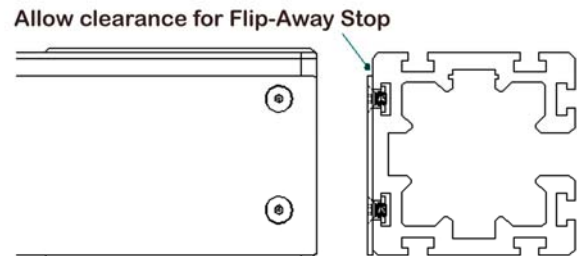
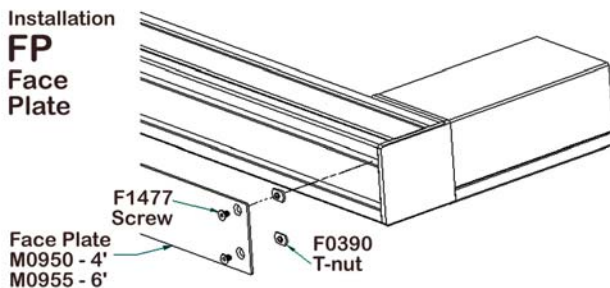

TigerStop Customer Service - Tel: +1 (360) 448-6102 - Fax: +1 (360) 260-0755 - Email: service@tigerstop.com - Webpage: www.tigerstop.com

© 2007-2011 TigerStop LLC. All rights reserved.